

PXie Series High Performance Industrial Printer – Configuration Guide



PX4ie
4-inch

PX4ie – 203DPI

PX4E010000005120 PX4E, LCD, Universal firmware, Ethernet, USB, Serial, Label Taken Sensor + Self Strip, Real Time Clock, Direct Thermal and Thermal Transfer, 203DPI, No Power Cord

PX4ie – 300DPI

PX4E010000005130 PX4E, LCD, Universal firmware, Ethernet, USB, Serial, Label Taken Sensor + Self Strip, Real Time Clock, Direct Thermal and Thermal Transfer, 300DPI, No Power Cord

PX4ie – 406DPI

PX4E010000005140 PX4E, LCD, Universal firmware, Ethernet, USB, Serial, Label Taken Sensor + Self Strip, Real Time Clock, Direct Thermal and Thermal Transfer, 406DPI, No Power Cord

Honeywell Repair Services

SVCPX4I-SG3N PX4i, Edge Service, GOLD Support Contract, 5 Day, 3 Year



PX6ie
6-inch

PX6ie – 203DPI

PX6E010000001120 PX6E, LCD, Universal firmware, Ethernet, USB, Serial, Label Taken Sensor + Self Strip, Real Time Clock, Direct Thermal and Thermal Transfer, 203DPI, No Power Cord

PX6ie – 300DPI

PX6E010000001130 PX6E, LCD, Universal firmware, Ethernet, USB, Serial, Label Taken Sensor + Self Strip, Real Time Clock, Direct Thermal and Thermal Transfer, 300DPI, No Power Cord

Honeywell Repair Services

SVCPX6I-SG3N PX6i, Edge Service, GOLD Support Contract, 5 Day, 3 Year

PXie Series High Performance Industrial Printer – Configuration Guide



PX4ie
4-inch

PX4ie – Cutter – 203DPI

PX4E010000003120	PX4E, LCD, Universal firmware, Ethernet, USB, Serial, Label Taken Sensor + Self Strip, Real Time Clock, Direct Thermal and Thermal Transfer, 203DPI, No Power Cord
------------------	--------------------------------------------------------------------------------------------------------------------------------------------------------------------

PX4ie – Cutter – 300DPI

PX4E010000003130	PX4E, LCD, Universal firmware, Ethernet, USB, Serial, Label Taken Sensor + Self Strip, Real Time Clock, Direct Thermal and Thermal Transfer, 300DPI, No Power Cord
------------------	--------------------------------------------------------------------------------------------------------------------------------------------------------------------

PX4ie – Cutter – 406DPI

PX4E010000003140	PX4E, LCD, Universal firmware, Ethernet, USB, Serial, Label Taken Sensor + Self Strip, Real Time Clock, Direct Thermal and Thermal Transfer, 406DPI, No Power Cord
------------------	--------------------------------------------------------------------------------------------------------------------------------------------------------------------

Honeywell Repair Services

SVCPX4I-SG3N	PX4i, Edge Service, GOLD Support Contract, 5 Day, 3 Year
SVCCUTTER1-PRN3	Add-On, Edge Service, Cutter Service, Printer, 3 Year



PX6ie
6-inch

PX6ie – Cutter – 203DPI

PX6E010000003120	PX6E, LCD, Universal firmware, Ethernet, USB, Serial, Label Taken Sensor + Self Strip, Real Time Clock, Direct Thermal and Thermal Transfer, 203DPI, No Power Cord
------------------	--------------------------------------------------------------------------------------------------------------------------------------------------------------------

PX6ie – Cutter – 300DPI

PX6E010000003130	PX6E, LCD, Universal firmware, Ethernet, USB, Serial, Label Taken Sensor + Self Strip, Real Time Clock, Direct Thermal and Thermal Transfer, 300DPI, No Power Cord
------------------	--------------------------------------------------------------------------------------------------------------------------------------------------------------------

Honeywell Repair Services

SVCPX6I-SG3N	PX6i, Edge Service, GOLD Support Contract, 5 Day, 3 Year
SVCCUTTER1-PRN3	Add-On, Edge Service, Cutter Service, Printer, 3 Year

PXie Series High Performance Industrial Printer – Configuration Map

Version	Firmware	Connectivity	I/O Option	I/O Option	Memory	Media Option	Media Option	RTC Option	Print Option	Description	Notes
PX											
4E										4-inch	
6E										6-inch	
	0									Universal Firmware	Fingerprint (FP), Direct Protocol (DP), IPL, ZSim2 (ZPL-II), DPL XML enabled for SAP® All and Oracle® WMS
		1								Ethernet, USB, Serial	
		2								USB + Serial + Ethernet + Wi-Fi (NA)	Available as kit – Part# 50147002-001, KIT Wireless LAN (North America)
		3								USB + Serial + Ethernet + Wi-Fi (ROW)	Available as kit – Part# 50147002-002, KIT Wireless LAN (Rest Of World)
			00							None	
			10							Parallel	Available as kit – Part# 50147017-001, KIT, IEEE 1284 Interface, PX REFRESH
			02							UHF RFID EU	PX4E - Available as kit – Part# 50147010-001, KIT RFID, 869MHZ, PX4I REFRESH, EU PX6E - Available as kit – Part# 50147012-001 KIT RFID , 869MHZ, PX6I REFRESH, EU
			14							UHF RFID US	PX4E - Available as kit – Part# 50147009-001, KIT RFID, 915MHZ, PX4I REFRESH, NA PX6E - Available as kit – Part# 50147011-001, KIT RFID, 915MHZ, PX6I REFRESH, NA
				00						None	
					0					128 MB Flash memory, 256 MB DDR2 SDRAM	
						0				Rotating Unwinding Media Hanger	
							0			None	
							1			Rewinder, Self-Strip + Label Taken Sensor (LTS)	PX6E
							3			Cutter	PX4E - Available as kit – Part# 1-041574-900, KIT CUTTER, PX4I REFRESH PX6E - Available as kit – Part# 1-041584-900, KIT CUTTER, PX6I REFRESH
							5			Rewinder, Enhanced Self-Strip + Label Taken Sensor (LTS)	Enhanced Self-Strip option for PX4E
								1		Real Time Clock (RTC)	
									20	203 DPI	PX4E - Available as kit – Part# 1-040082-900, THERMAL PH ASSY 203 DPI PX4I PX6E - Available as kit – Part# 1-040084-900, THERMAL PH ASSY 203 DPI PX6I
									30	300 DPI	PX4E - Available as kit – Part# 1-040083-900, THERMAL PH ASSY 300 DPI PX4I PX6E - Available as kit – Part# 1-040085-900, THERMAL PH ASSY 300 DPI PX6I
									40	406 DPI	PX4E - Available as kit – Part# 850-812-900, THERMAL PH ASSY 406 DPI PX4I





Honeywell Repair Services

PX4ie – Repair Services

For Best-In-Class Service

With Honeywell Repair Services, it’s easy to get the level of repair coverage and protection that makes the most sense for your business. And our repair services are now available in over 70 countries with global pricing and global standards of quality.

Choose from one of our new cost-effective Repair Service contract programs – Complete, Plus or Basic – to get the right amount of coverage and protection you need for your durable, rugged and ultra-rugged products. And for equipment not covered by a contract service plan, you can choose from our Non-Contract Repair Service offerings, which include flat-rate repairs, time-and-materials repairs and more.

Ensure business continuity, workflow performance and protection of your technology investments with Honeywell Repair Services.

Gold Edge Services

Protect your technology investment! With Honeywell’s 3 and 5 year Gold comprehensive repair services plan, you won’t incur any additional costs beyond the plan enrollment for service on covered devices and eligible accessories included with equipment sent to the depot for service. Eligible accessories include damaged styluses, battery-door covers, screen protectors, hand straps and clips.

Part Number	Description
SVCPX4I-SG3N	PX4i, Edge Service, GOLD Support Contract, 5 Day, 3 Year New Contract, Contract includes repairs or replacement of damaged or defective components. Does not provide replacement devices.
SVCCUTTER1-PRN3	Add-On, Edge Service, Cutter Service, Printer, 3 Year
SVCPRINHEAD-PRN3	Add-On, Edge Service, 203 DPI Printhead Replacement Service, 3 Year
SVCREPLACE-PRN3	Add-On, Edge Service, Device Replacement, Printer, 3 Year
SVCSPAREMGMT-PRN3	Add-On, Edge Service, Advanced Exchange, Printer, 3 Year
SVCPX4I-SG5N	PX4i, Edge Service, GOLD Support Contract, 5 Day, 5 Year New Contract, Contract includes repairs or replacement of damaged or defective components. Does not provide replacement devices
SVCCUTTER1-PRN5	Add-On, Edge Service, Cutter Service, Printer, 5 Year
SVCPRINHEAD-PRN5	Add-On, Edge Service, 203 DPI Printhead Replacement Service, 5 Year
SVCREPLACE-PRN5	Add-On, Edge Service, Device Replacement, Printer, 5 Year
SVCSPAREMGMT-PRN5	Add-On, Edge Service, Advanced Exchange, Printer, 5 Year

Platinum Edge Services

The only contract you will ever need! With Honeywell’s 3 and 5 year Platinum comprehensive repair services plan, one contract covers it all – device, power management and accessories. Eligible accessories and power management for mobile computers include: batteries, docks, chargers, cradles, cables, damaged styluses, battery-door covers, screen protectors, hand straps and clips.

Part Number	Description
SVCPX4I-SP3N	PX4i, Edge Service, PLATINUM, 2 Day, 3 Year, New Contract. Service includes, Device Replacement, 1 Printhead, Accessory Replacement, and Operational Intelligence License.
SVCCUTTER1-PRN3	Add-On, Edge Service, Cutter Service, Printer, 3 Year
SVCPRINHEAD-PRN3	Add-On, Edge Service, 203 DPI Printhead Replacement Service, 3 Year
SVCSPAREMGMT-PRN3	Add-On, Edge Service, Advanced Exchange, Printer, 3 Year
SVCPX4I-SP5N	PX4i, Edge Service, PLATINUM, 2 Day, 5 Year, New Contract. Service includes, Device Replacement, 2 Printheads, Accessory Replacement, and Operational Intelligence License.
SVCCUTTER1-PRN5	Add-On, Edge Service, Cutter Service, Printer, 5 Year
SVCPRINHEAD-PRN5	Add-On, Edge Service, 203 DPI Printhead Replacement Service, 5 Year
SVCSPAREMGMT-PRN5	Add-On, Edge Service, Advanced Exchange, Printer, 5 Year



Honeywell Repair Services

PX6ie – Repair Services

For Best-In-Class Service

With Honeywell Repair Services, it’s easy to get the level of repair coverage and protection that makes the most sense for your business. And our repair services are now available in over 70 countries with global pricing and global standards of quality.

Choose from one of our new cost-effective Repair Service contract programs – Complete, Plus or Basic – to get the right amount of coverage and protection you need for your durable, rugged and ultra-rugged products. And for equipment not covered by a contract service plan, you can choose from our Non-Contract Repair Service offerings, which include flat-rate repairs, time-and-materials repairs and more.

Ensure business continuity, workflow performance and protection of your technology investments with Honeywell Repair Services.

Gold Edge Services

Protect your technology investment! With Honeywell’s 3 and 5 year Gold comprehensive repair services plan, you won’t incur any additional costs beyond the plan enrollment for service on covered devices and eligible accessories included with equipment sent to the depot for service. Eligible accessories include damaged styluses, battery-door covers, screen protectors, hand straps and clips.

Part Number	Description
SVCPX6I-SG3N	PX6i, Edge Service, GOLD Support Contract, 5 Day, 3 Year New Contract, Contract includes repairs or replacement of damaged or defective components. Does not provide replacement devices.
SVCCUTTER1-PRN3	Add-On, Edge Service, Cutter Service, Printer, 3 Year
SVCPRINTHEAD-PRN3	Add-On, Edge Service, 203 DPI Printhead Replacement Service, 3 Year
SVCREPLACE-PRN3	Add-On, Edge Service, Device Replacement, Printer, 3 Year
SVCSPAREMGMT-PRN3	Add-On, Edge Service, Advanced Exchange, Printer, 3 Year
SVCPX6I-SG5N	PX6i, Edge Service, GOLD Support Contract, 5 Day, 5 Year New Contract, Contract includes repairs or replacement of damaged or defective components. Does not provide replacement devices
SVCCUTTER1-PRN5	Add-On, Edge Service, Cutter Service, Printer, 5 Year
SVCPRINTHEAD-PRN5	Add-On, Edge Service, 203 DPI Printhead Replacement Service, 5 Year
SVCREPLACE-PRN5	Add-On, Edge Service, Device Replacement, Printer, 5 Year
SVCSPAREMGMT-PRN5	Add-On, Edge Service, Advanced Exchange, Printer, 5 Year

Platinum Edge Services

The only contract you will ever need! With Honeywell’s 3 and 5 year Platinum comprehensive repair services plan, one contract covers it all – device, power management and accessories. Eligible accessories and power management for mobile computers include: batteries, docks, chargers, cradles, cables, damaged styluses, battery-door covers, screen protectors, hand straps and clips.

Part Number	Description
SVCPX6I-SP3N	PX6i, Edge Service, PLATINUM, 2 Day, 3 Year, New Contract. Service includes, Device Replacement, 1 Printhead, Accessory Replacement, and Operational Intelligence License.
SVCCUTTER1-PRN3	Add-On, Edge Service, Cutter Service, Printer, 3 Year
SVCPRINTHEAD-PRN3	Add-On, Edge Service, 203 DPI Printhead Replacement Service, 3 Year
SVCSPAREMGMT-PRN3	Add-On, Edge Service, Advanced Exchange, Printer, 3 Year
SVCPX6I-SP5N	PX6i, Edge Service, PLATINUM, 2 Day, 5 Year, New Contract. Service includes, Device Replacement, 2 Printheads, Accessory Replacement, and Operational Intelligence License.
SVCCUTTER1-PRN5	Add-On, Edge Service, Cutter Service, Printer, 5 Year
SVCPRINTHEAD-PRN5	Add-On, Edge Service, 203 DPI Printhead Replacement Service, 5 Year
SVCSPAREMGMT-PRN5	Add-On, Edge Service, Advanced Exchange, Printer, 5 Year

Honeywell Repair Services

PXie Series – Repair Services

For Best-In-Class Service

PX4ie



PX6ie



Warranty Cover Against Product Defect

BASIC Service

Comprehensive Coverage:

- Device Replacement (Add-On)
- Accidental Damage
- Wear & Tear

Includes Replacement of:

- Platen Roller

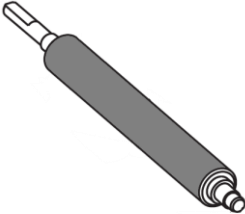

GOLD Service

Platinum Coverage

- Limited Printhead Replacement
- Operational Intelligence
- Accidental Damage
- Device Replacement
- Wear & Tear



Printhead
(3 Year – 1 Printhead Replacement)
(5 Year – 2 Printhead Replacement)

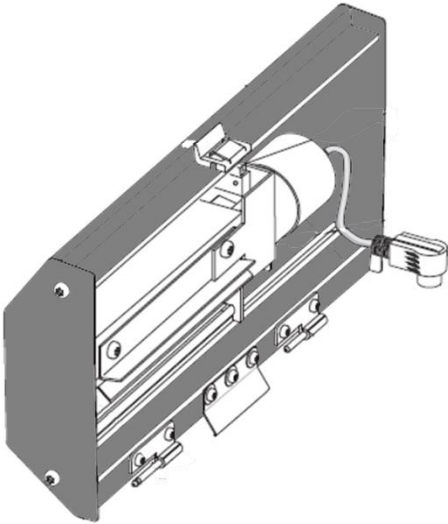

Cutter

PLATINUM Service

Part Number	Description
SVCPX4-EXW2	PX4i, BASIC, 10-15 Day Turnaround, 2 Years (1 Year Factory Warranty + 1 Year Extended)
SVCPX4I-SG3N	PX4i, Edge Service, GOLD Support Contract, 5 Day, 3 Year
SVCPX4I-SP3N	PX4i, Edge Service, PLATINUM, 2 Day, 3 Year Includes 1 Printhead, Platen Rollers and Replacement Printers

Part Number	Description
SVCPX6-EXW2	PX6i, BASIC, 10-15 Day Turnaround, 2 Years (1 Year Factory Warranty + 1 Year Extended)
SVCPX6I-SG3N	PX6i, Edge Service, GOLD Support Contract, 5 Day, 3 Year
SVCPX6I-SP3N	PX6i, Edge Service, PLATINUM, 2 Day, 3 Year Includes 1 Printhead, Platen Rollers and Replacement Printers

PXie Series High Performance Industrial Printer

PXie Series – Connectivity

Expand your I/O with additional cards.



Part#	Description
50147018-001	KIT, DUART Interface RS232+RS232 (RS-232, RS-422, RS-485, and 20 mA Current Loop)

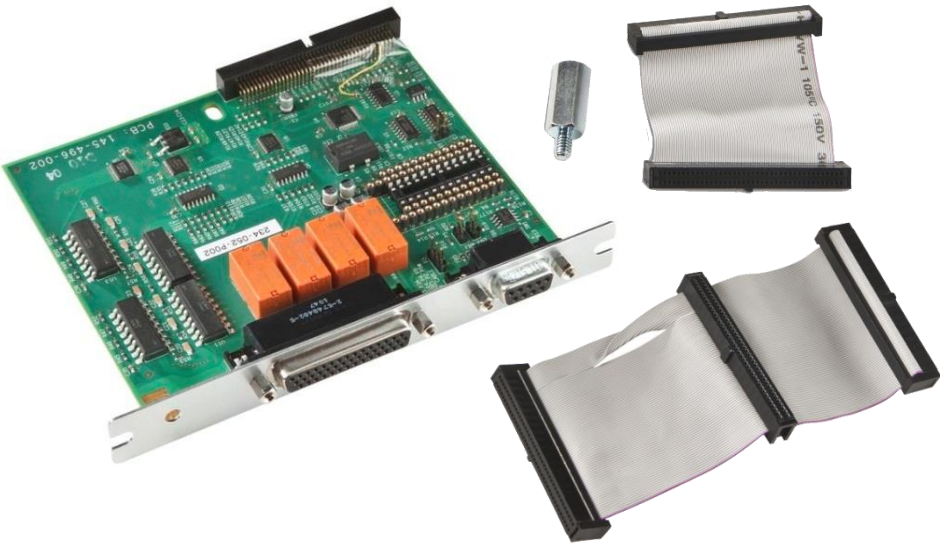

Part#	Description
50147001-001	Applicator Interface Card
The applicator interface supports applicator signals with 8 digital IN ports with optocouplers, 8 digital Out ports with optocouplers, and 4 OUT ports with relays. All signals are available on a DB44 pin socket.	

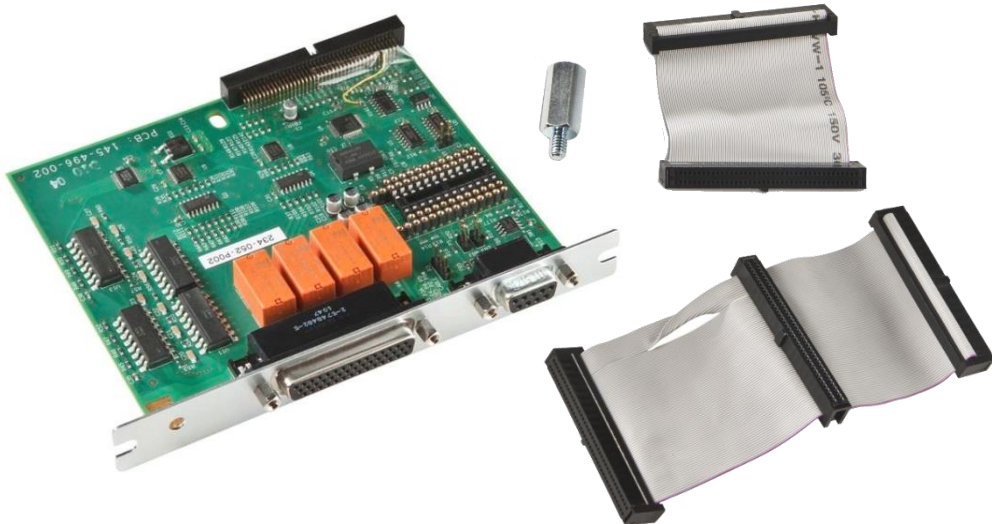

Part#	Description
50147019-001	UART Industrial Interface Card (DB44 8 digital in/out, 4 analogue relays, DB9 RS-232/422/485 port)



Part#	Description
50147017-001	KIT, PARALLEL PORT (Adds IEEE1284 Parallel Port) Use with Part# 1-974022-018 Parallel Cable

PXie Series High Performance Industrial Printer

PXie Series – Connectivity

Expand your I/O with additional cards.

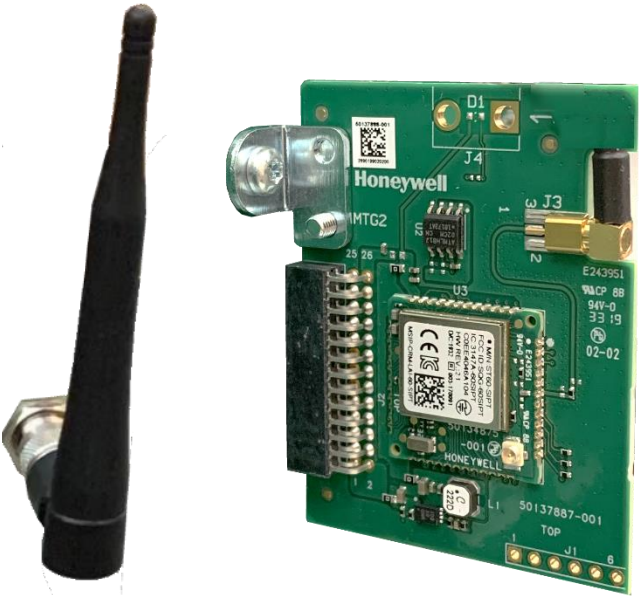
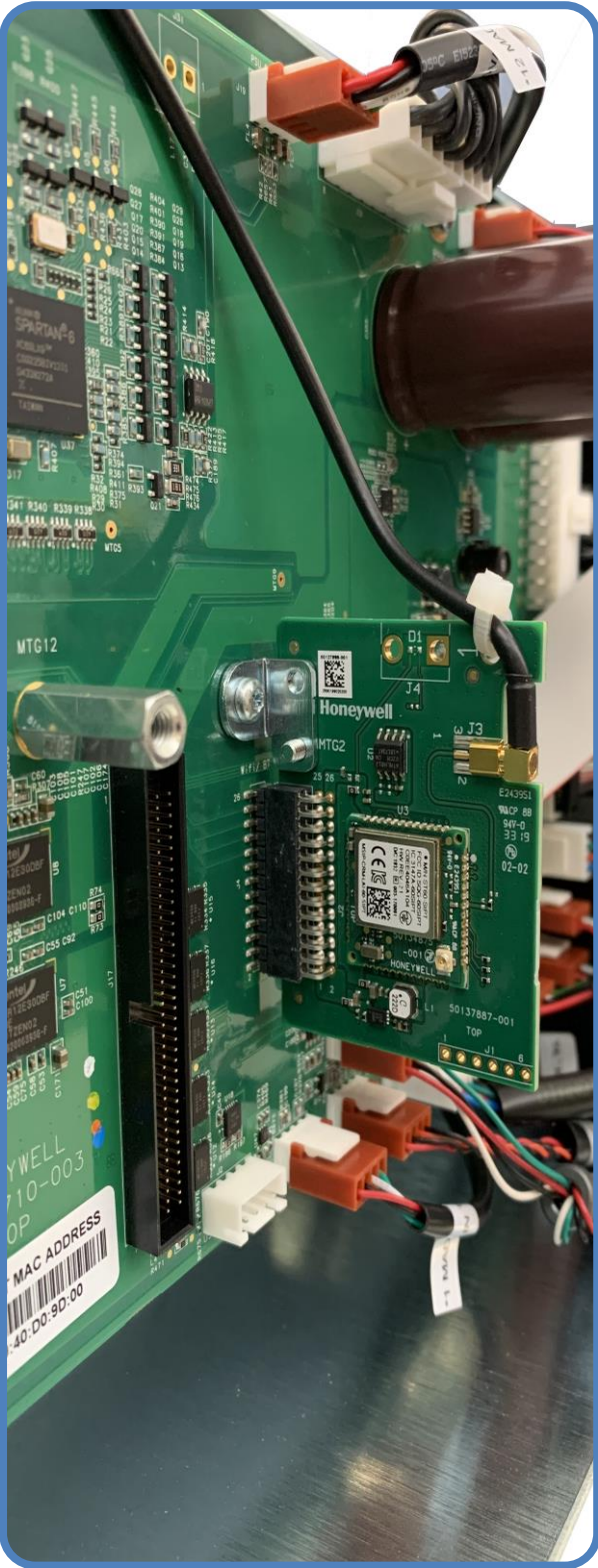

Part#	Description
50147002-001	KIT Wireless LAN (North America)
50147002-002	KIT Wireless LAN (Rest Of World)

IEEE 802.11 a/b/g/n/ac WEP, WPA, WPA2
802.11x (EAP TTLS, LEAP, PEAP, FAST)
(Requires a technician to install as it involves opening the printer electronics cover.)

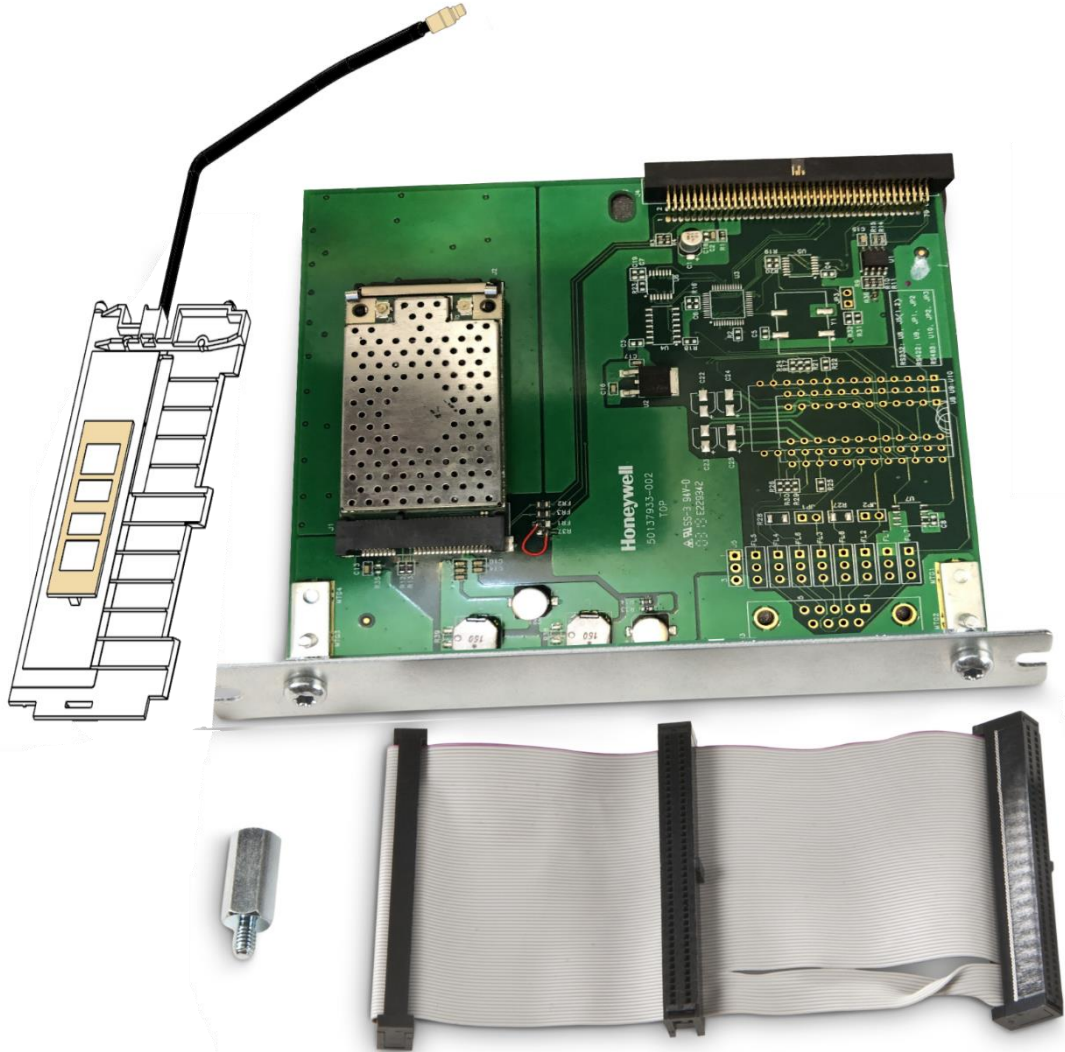

Model	Part#	Description
PX4E	50147009-001	KIT RFID, 915MHz, PX4I REFRESH, North America
PX4E	50147010-001	KIT RFID, 869MHz, PX4I REFRESH, EU
PX6E	50147011-001	KIT RFID, 915MHz, PX6I REFRESH, North America
PX6E	50147012-001	KIT RFID, 869MHz, PX6I REFRESH, EU

This RFID kit uses the IM11 UHF RFID module.

PXie Series High Performance Industrial Printer

PXie Series – Accessories

The PXie Series auto detects the printhead, therefore you can simply swap between 203, 300 and 406dpi *



Model	Part#	Description
PX4E	1-040082-900	KIT, PRINthead 203DPI, PX4i
PX4E	1-040083-900	KIT, PRINthead 300DPI, PX4i
PX4E	850-812-900	KIT, PRINthead 406DPI, PX4i
PX6E	1-040084-900	KIT, PRINthead 203DPI, PX6i
PX6E	1-040085-900	KIT, PRINthead 300DPI, PX6i



Part#	Description
1-110501-00	Cleaning Card, 4.5"x6", box of 25



Part#	Description
321-576-004	USB (USB-A to USB-B) cable, 6.5 ft. (2 m) length



Part#	Description
1-974024-018	RS-232 (DB9F to DB9M) cable, 5.9 ft. (1.8 m) length



Part#	Description
1-974022-018	Parallel (IEEE 1284) cable, 5.9 ft. (1.8 m) length

* Please refer to Thermal Printhead Installation Instructions on how to change the printhead.

PXie Series High Performance Industrial Printer

OEM PX4ie Printer Kit Options (4-inch)

See below the different printing options available:

PX4i Base Kit 1

All Base 1 Print Kits include:

- Print module with either a 203-dpi or 300-dpi printhead.
- Main logic board for controlling the print hardware and communicating with your controller.
- AC power supply.

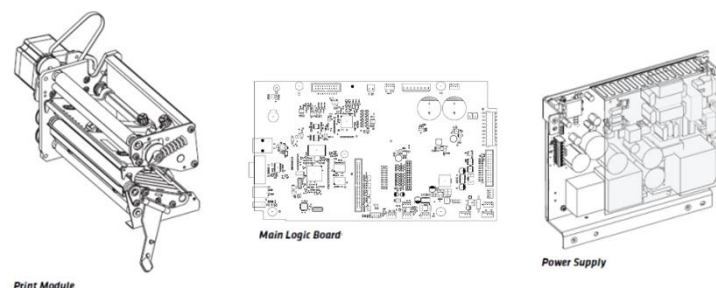

50147091-001 Print Kit PX4 (203DPI) Base 1

50147092-001 Print Kit PX4 (300DPI) Base 1

PX4i Base Kit 2

All Base 2 Print Kits include:

- Print module with either a 203-dpi or 300-dpi printhead.
- Main logic board for controlling the print hardware and communicating with your controller.
- AC power supply.
- Keyboard and LCD display for printer messages and information.

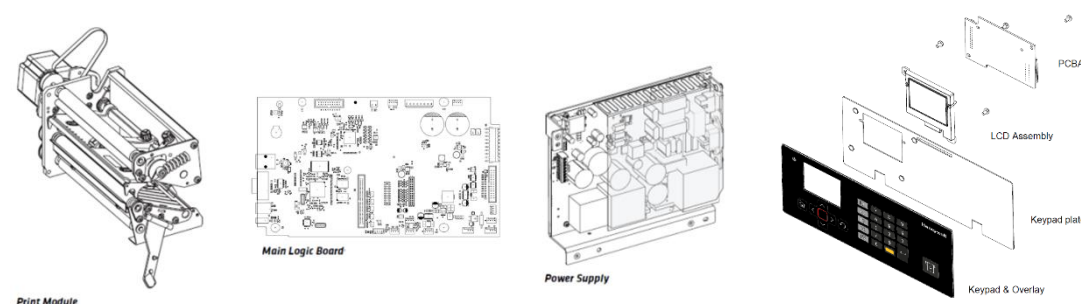

50147093-001 Print Kit PX4 (203DPI) Base 2

50147094-001 Print Kit PX4 (300DPI) Base 2

Option Kit 1 – PX4i Thermal Transfer

Option Kit 1 includes components for supplying thermal transfer ribbon to the print mechanism.

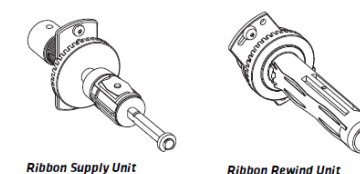

50147095-001 Option Kit 1 PX4 Thermal Transfer

Option Kit 2 – PX4i Media Supply Assembly

Option Kit 2 includes components for supplying media to the print mechanism.

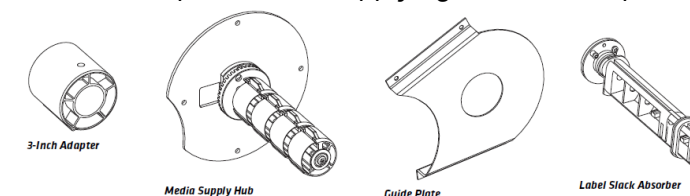

50147096-001 Option Kit 2 PX4 Media Supply Assembly

Option Kit 3 – PX4i Self-Strip

Option Kit 3 includes components for self-strip operation.

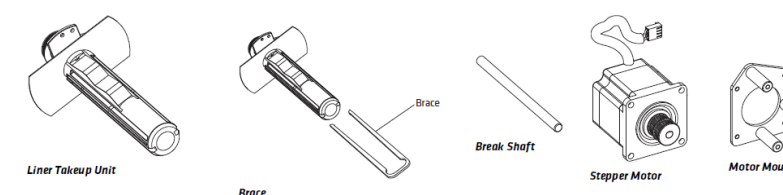

50147097-001 Option Kit 3 PX4 Self-Strip

Option Kit 4 – PX4i Chassis

Option Kit 4 includes chassis parts that are pre-drilled for use with the PX4i Print Kit components. This kit includes center, bottom, and back plates as used in the PX4i printers.

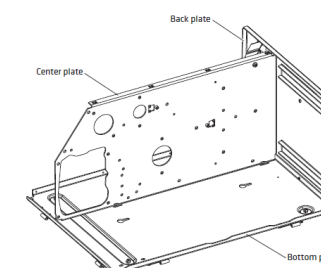

50147098-001 Option Kit 4 PX4 Chassis

PXie Series High Performance Industrial Printer

OEM PX6ie Printer Kit Options (6-inch)

See below the different printing options available:

PX6i Base Kit 1

All Base 1 Print Kits include:

- Print module with either a 203-dpi or 300-dpi printhead.
- Main logic board for controlling the print hardware and communicating with your controller.
- AC power supply.



50147099-001 Print Kit PX6 (203DPI) Base 1

50147100-001 Print Kit PX6 (300DPI) Base 1

PX6i Base Kit 2

All Base 2 Print Kits include:

- Print module with either a 203-dpi or 300-dpi printhead.
- Main logic board for controlling the print hardware and communicating with your controller.
- AC power supply.
- Keyboard and LCD display for printer messages and information.

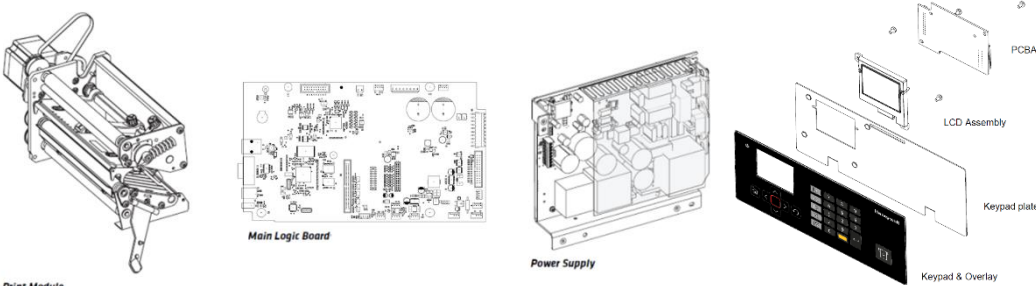

50147101-001 Print Kit PX6 (203DPI) Base 2

50147102-001 Print Kit PX6 (300DPI) Base 2

Option Kit 1 – PX6i Thermal Transfer

Option Kit 1 includes components for supplying thermal transfer ribbon to the print mechanism.

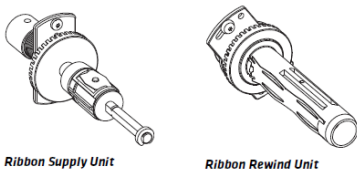

50147103-001 Option Kit 1 PX6 Thermal Transfer

Option Kit 2 – PX6i Media Supply Assembly

Option Kit 2 includes components for supplying media to the print mechanism.

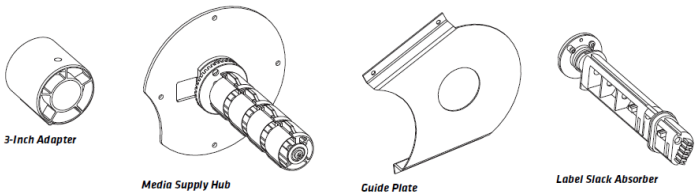

50147104-001 Option Kit 2 PX6 Media Supply Assembly

Option Kit 3 – PX6i Self-Strip

Option Kit 3 includes components for self-strip operation.

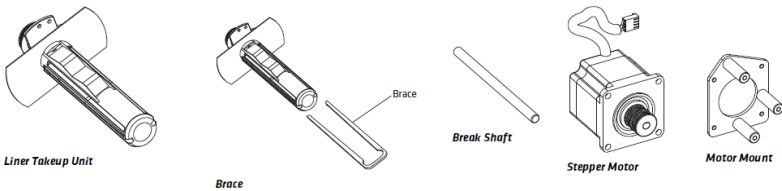

50147105-001 Option Kit 3 PX6 Self-Strip

Option Kit 4 – PX6i Chassis

Option Kit 4 includes chassis parts that are pre-drilled for use with the PX6i Print Kit components. This kit includes center, bottom, and back plates as used in the PX6i printers.

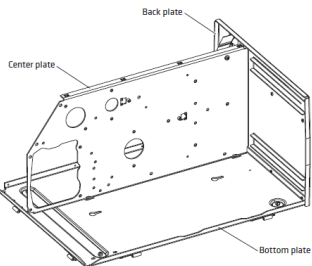

50147106-001 Option Kit 4 PX6 Chassis

PXie Series High Performance Industrial Printer

PXie – Printing Options

See below the different printing options available:

Tear Off

Most commonly used, print any number of labels and simply tear the labels off from the printer at the end of the print job.

Media Path

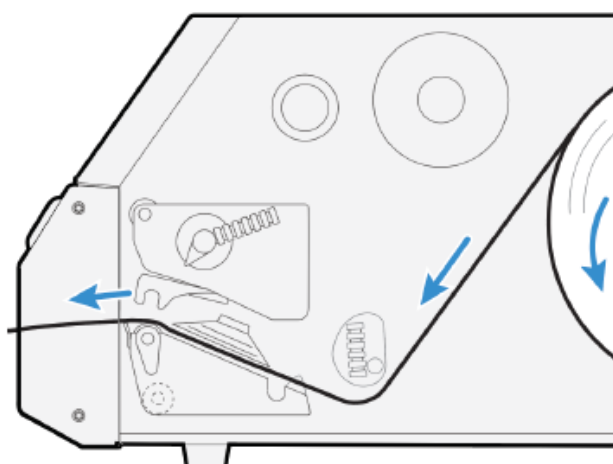

Peel and Present

Peels the label from the liner as it is printed and presents the label to the user one a time. Printing is halted after each label until the user remove the label. Requires Rewinder, Peel Off + Label Taken Sensor (LTS) option.

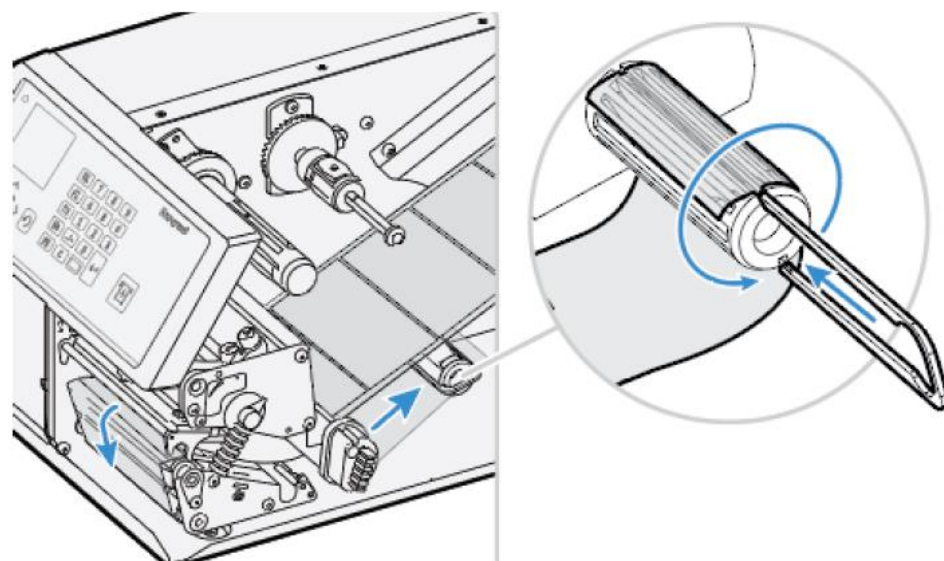

Fan Fold

The media is stacked outside the rear of the PXie, or the bottom access slot.

Feeding Media Through the Upper Slot

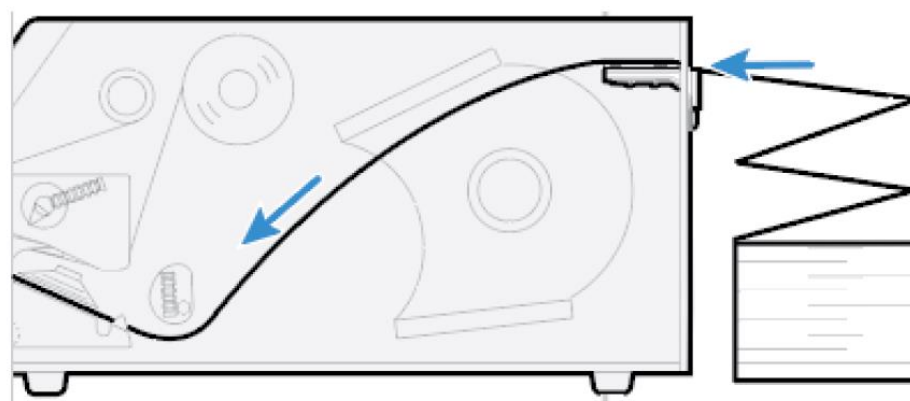

Feeding Media Through the Lower Slot

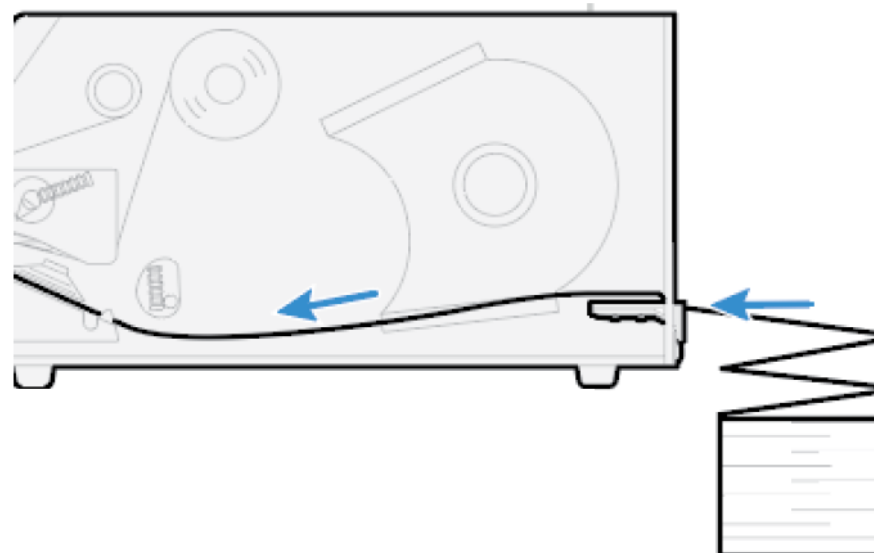

Cutter

A cutter can be added to any configuration of PXie, simply cutting between labels, or at intervals on continuous media.

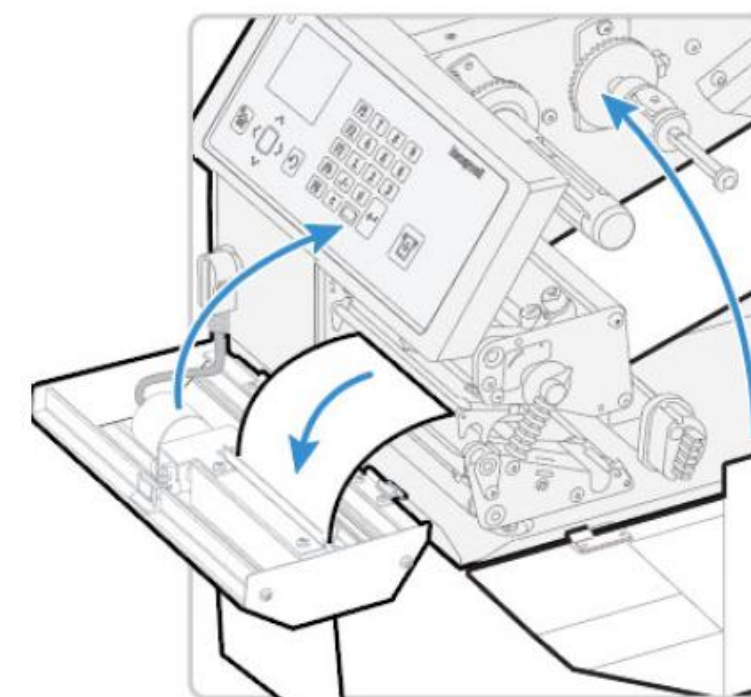

Miscellaneous



AC Cords

Part Number	Description
50117501-001	AC Power Cord, Australia
19-19807	AC Power Cord, China
9000091CABLE	AC Power Cord, Denmark
77900508E	AC Power Cord, Europe
50127245-001	AC Power Cord, India
9000092CABLE	AC Power Cord, Italy
321-500-002	AC Power Cord, Japan
9000093CABLE	AC Power Cord, Switzerland
77900507E	AC Power Cord, United Kingdom
19-19726	AC Power Cord, United States

Appendix

PX Keyboards – Compare PX4 to PX4ie

Compare the previous IPL and Fingerprint keyboards to the new PX4ie keyboard layout.

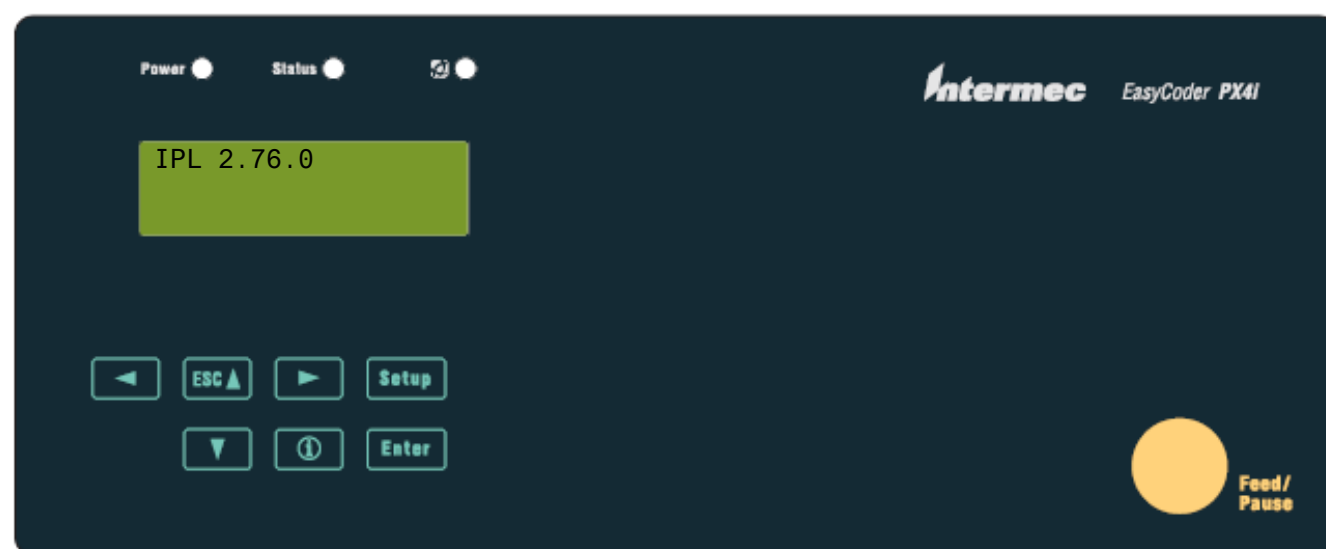

PX4A / PX4B - IPL

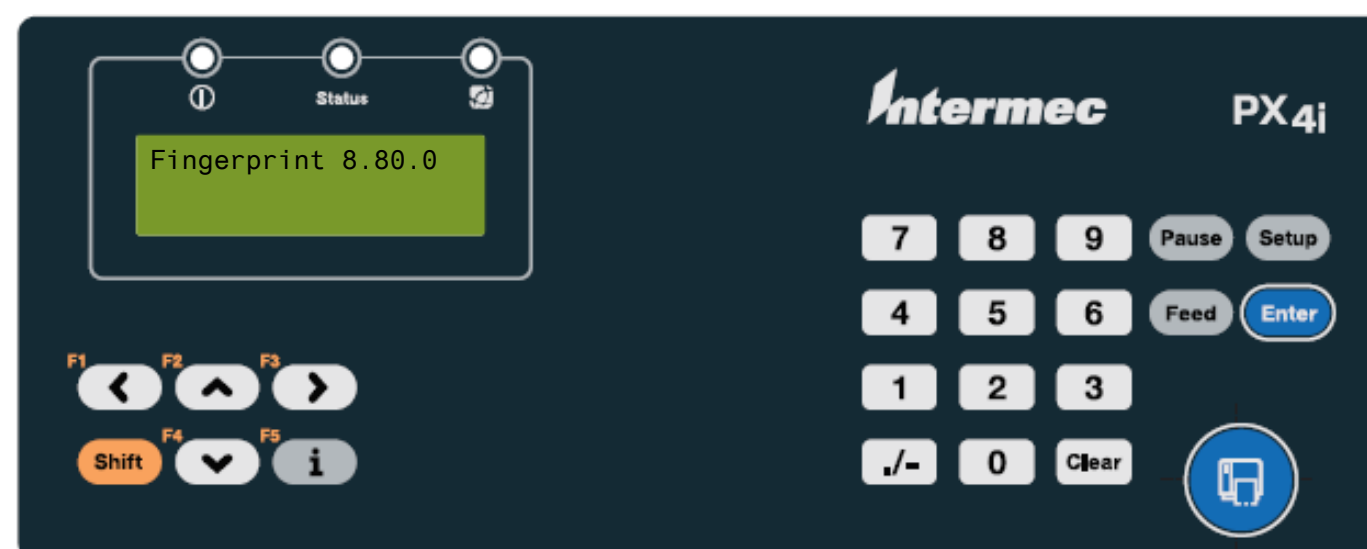

PX4C – Multi-Firmware



PX4A / PX4B - Fingerprint

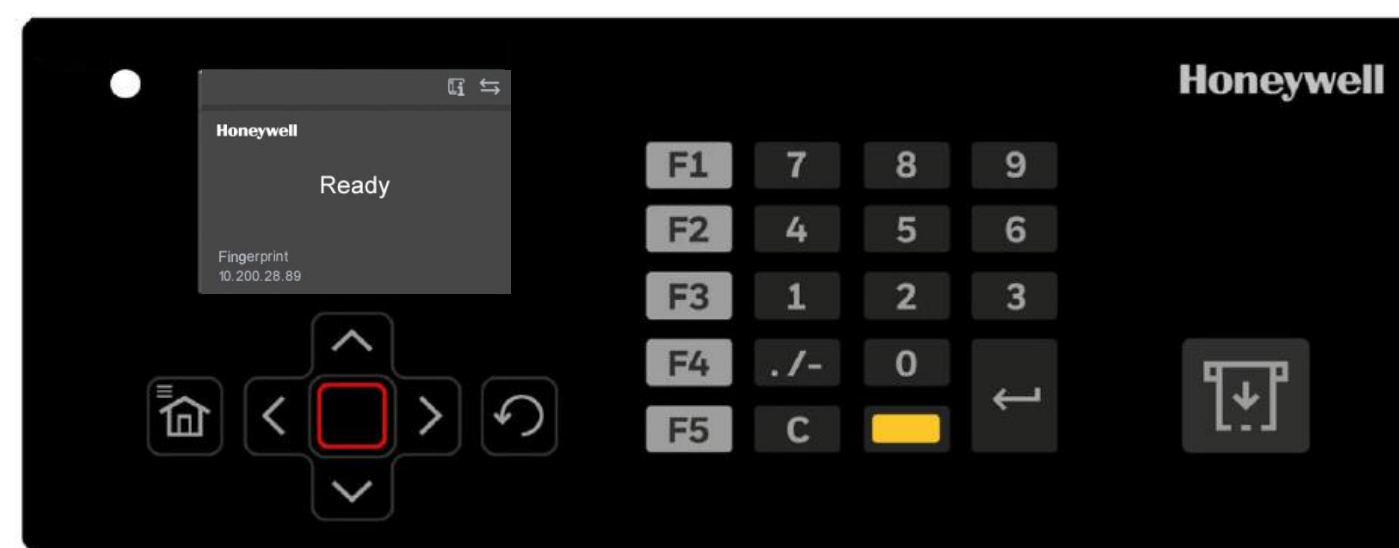

PX4E – Multi-Firmware

Appendix

PX Connectivity – Compare PX4 to PX4ie

Compare the previous communications ports.



PX4A/B/C	270-162-001	PX4, PX6, Legacy, Wireless Interface, North America Only
PX4A/B/C	270-162-002	PX4, PX6, Legacy, Wireless Interface, Rest Of World (ROW)

PX4E/ PX6E	50147002-001	KIT Wireless LAN (North America)
PX4E/ PX6E	50147002-002	KIT Wireless LAN (Rest Of World)

Appendix

PX Media Compartment – Compare PX4 to PX4ie

Compare the media compartment.



PX4A / PX4B / PX4C

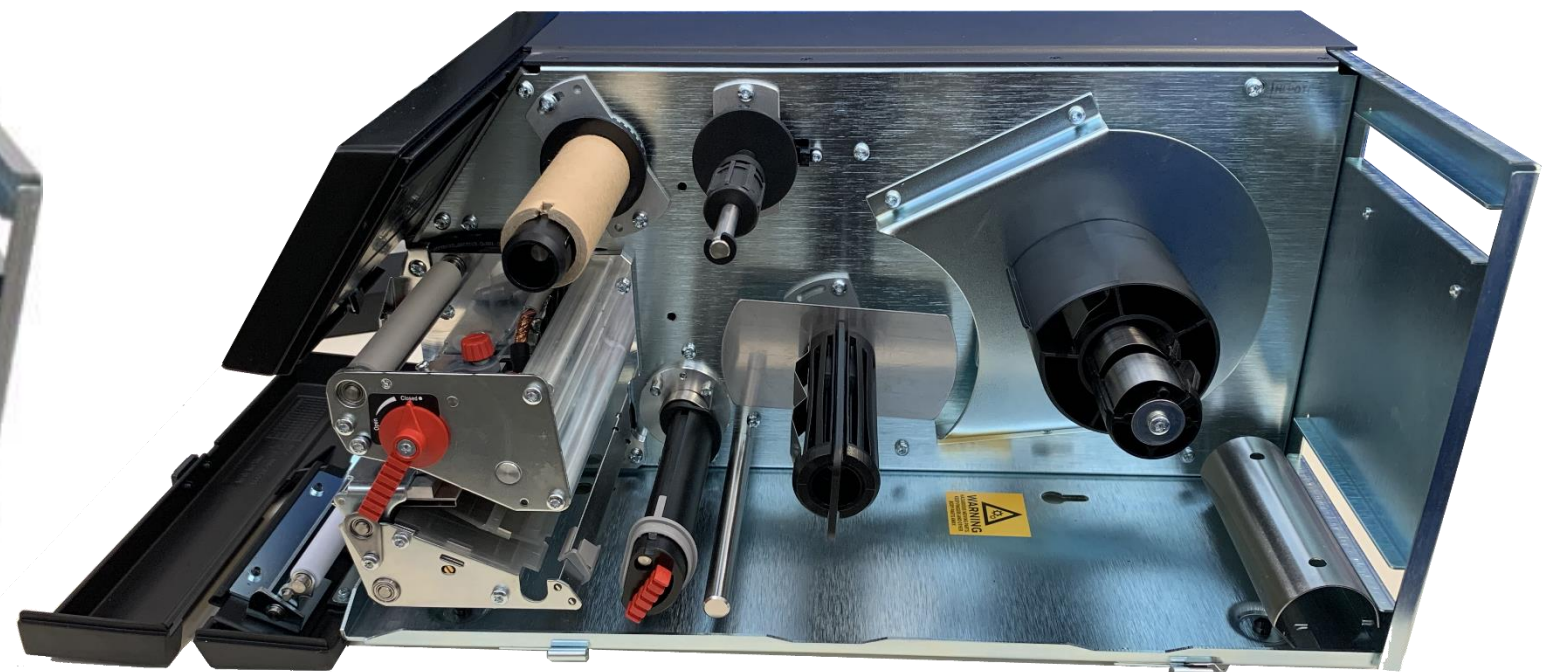

PX4E

Disclaimer

Honeywell International Inc. (“HII”) reserves the right to make changes in specification and other information contained in this document without prior notice, and the reader should in all cases consult HII to determine whether any such changes have been made. The information in this publication does not represent a commitment on the part of HII.

HII shall not be liable for technical or editorial errors or omissions contained herein; nor for incidental or consequential damages resulting the furnishing, performance, or use of this material.

This document contains proprietary information that is protected by copyright. All rights are reserved. No part of this document may be photocopied, reproduced, or translated into another language with-out prior written consent of HII.

Web Address: www.honeywellaidc.com

The Bluetooth trademarks are owned by Bluetooth SIG, Inc., U.S.A and licensed to Honeywell.

Other product names mentioned in the manual may be trademarks of registered trademarks of their respective companies and are the property of their respective owners.

All rights reserved.